

ASM195M SOLAR MODULE

MAXIMUM EFFICIENCY AND PERFORMANCE

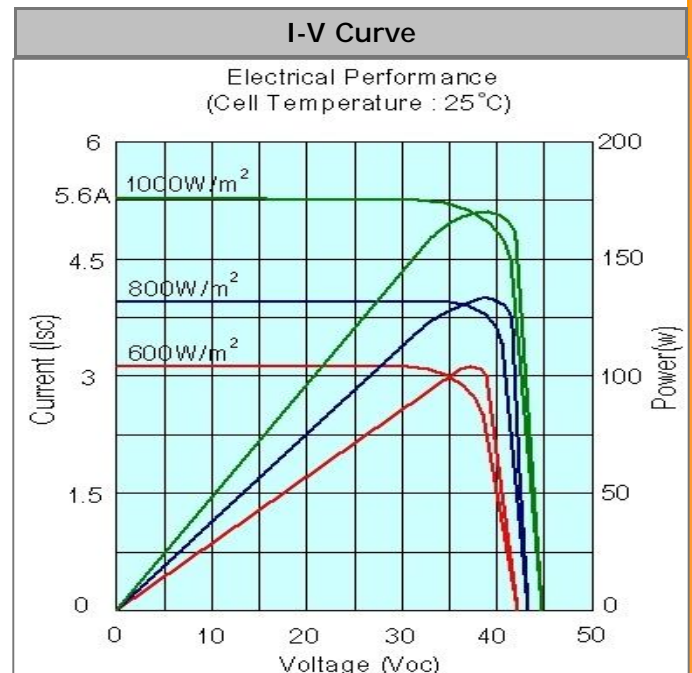

Electrical Data		
Measured at Standard Test Conditions (STC): Irradiance 1000W/m ² , AM 1.5, and cell temperature 25° C		
Nominal Power (+5/-3%)	P _{nom}	195 W
Efficiency	η	17.50%
Rated Voltage	V _{mp}	38.16 V
Rated Current	I _{mp}	5.32 A
Open Circuit Voltage	V _{oc}	45.216 V
Short Circuit Current	I _{sc}	5.6 A
Maximum System Voltage	IEC	1000 V
Temperature Coefficients Power (P)	(P)	-0.438% /°C
	Voltage (V _{oc})	-0.297mV/°C
	Current (I _{sc})	0.03%/ °C
NOCT		-40-/+85° C
Series Fuse Rating		10 A



Dimensions 1580 mm * 810 mm * 45 mm

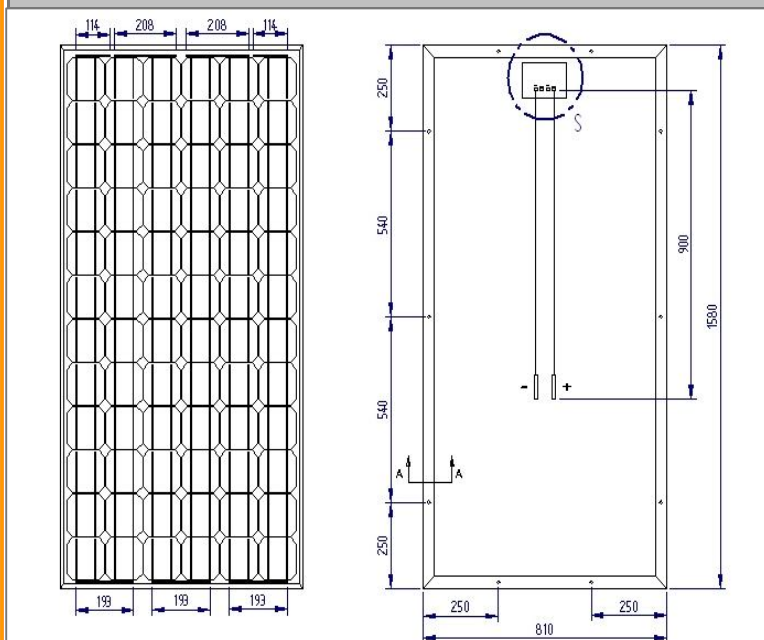

Current/voltage characteristics with dependence on irradiance and module temperature.

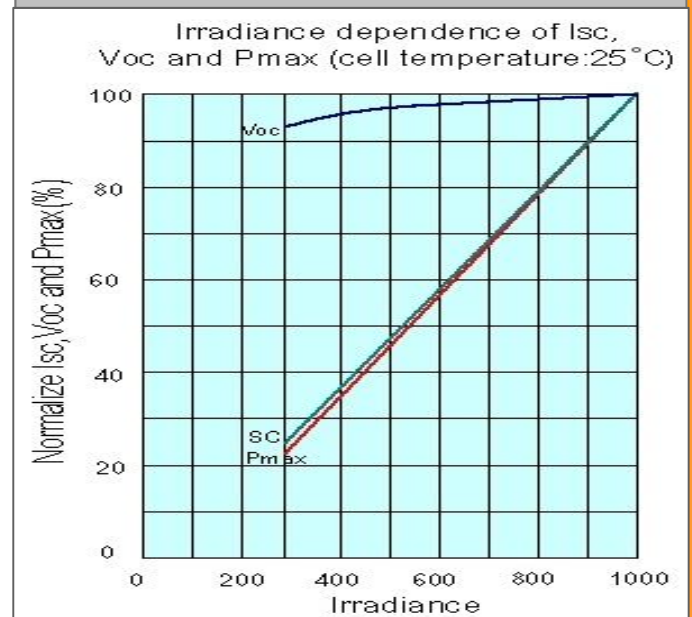

Mechanical data

Solar Cells	72 MonoCrystalline cells in a series	Output Cables	2 x 1000mm 4mm ² length cables / ZJRH connectors 05-6
Front Glass	High transmission tempered glass with anti-reflective (AR) coating	Frame	Silver Anodised Electrophoresis coating
Junction Box	IP-65 rated with 3 bypass diodes 32 x 155 x 128 (mm)	Weight	17 kg

CAUTION: READ SAFETY AND INSTALLATION INSTRUCTIONS BEFORE USING THE PRODUCT
 Visit www.australiansolarmanufacturing.com.au for details

UNIT 2, 37 RIMFIRE DRIVE, HALLAM, VICTORIA 3803
 PHONE: 61 3 87863461 FAX: 61 3 87863459 EMAIL: info@australiansolarmanufacturing.com.au

ASM and the ASM logo are trademarks of Australian Solar Manufacturing Pty Ltd.
 © November 2011 Australian Solar Manufacturing Pty Ltd. All rights reserved. Specifications included in this datasheet are subject to change without notice.